

Efficient, Innovative, Sustainable

Trimo modular space solutions











Al Wasita remote site camp, United Arab Emirates



Government

Trimo has built an enviable reputation as one of the leading providers of complete camp solutions to support military and relief operations, non-government organizations and other customers that demand a rugged, re-locatable building for use in remote areas across the globe. Trimo offers specialized, reinforced products that help keep occupants safe in some of the most dangerous locations.

Trimo's modular solutions are also used extensively by public and private investors as permanent, easy to set up and efficient hospitals, senior citizen accommodations, public infrastructure buildings and other social building applications.

Industrial

Sometimes industry requires factories or operations to be located in remote locations and this can mean sending the workforce to some of the harshest environments for extended periods. Typically this may be mining, oil exploration, telecommunications and energy installations, which may need to be located in hot deserts to northern cooler climates and it is here where Trimo's complete camp solutions excel. Safe, comfortable and inviting places to live and work, they offer the ultimate solution. Trimo also offers a wide range of modular units that have been optimised for use as telecom installations, industrial applications and other bespoke applications and its engineers work with the best materials to adapt to any specific customers requirements.



Kindergarten Ravne na Koroskem, Slovenia



Education

Where additional space is required quickly and efficiently, Trimo's modular units are the perfect solution for creating larger classrooms, complete schools, kindergartens, playrooms and many other educational applications. The units are flexible in dimensions and materials so that the perfect environment can be created for children.

Living conditions in Trimo's buildings are in compliance with all standards and regulations, and the use of top-quality contemporary materials and advanced manufacturing procedures guarantee long life-span. With the highest fire ratings and load bearing (earthquake and wind loads) capacities Trimo's modular units are always safe and secure.



Conhouse 2+ Weekend House, Slovenia



Benefits & Advantages

Best products and materials

- No. 1 in the industry in terms of quality.
- Excellent thermal insulation over the complete life span of the unit due to special panel joints and high density rock wool core.
- Non-flammable and environmental friendly materials.
- Windows and doors to the highest European quality standards.
- Panel joints designed to stop the ingress of desert sand and other environmental elements.

Flexible and cost effective

- Flexible design to meet individual requirements.
- Strong steel metal frame allows side-by-side and stacking of units in two or more storeys.
- Can be assembled and disassembled multiple times.
- Assembled unit designed to allow relocation of units from site to site without damage.
- Quick and on-time supply from our factories in EU to any destination around the globe.
- Flat-packed delivery minimises transportation costs.



www.roglab.si



Easy to assemble

- Easy and very fast assembly with minimal tools.
- No constructional waste.
- Significantly shorter construction times compared to traditional build.
- Simple foundations.

Support and consulting

- Complete engineering and project management support.
- Technical team of architects, experts in statics, civil and mechanical engineers make design plans with an ear to the customer.
- Free technical and after sales support.
- Detailed knowledge of the technological design processes, steel and modular construction assemblies.

High standard of living environment

- 30+ years life span with the correct maintenance.
- Sustainable and durable materials create a healthy and pleasant living environment.
- Strict quality control of all prefabrication process assures the very best final product.
- Numerous and global certificates for safety, quality and sustainability endorse our solutions.
- Excellent sound and heat insulation.

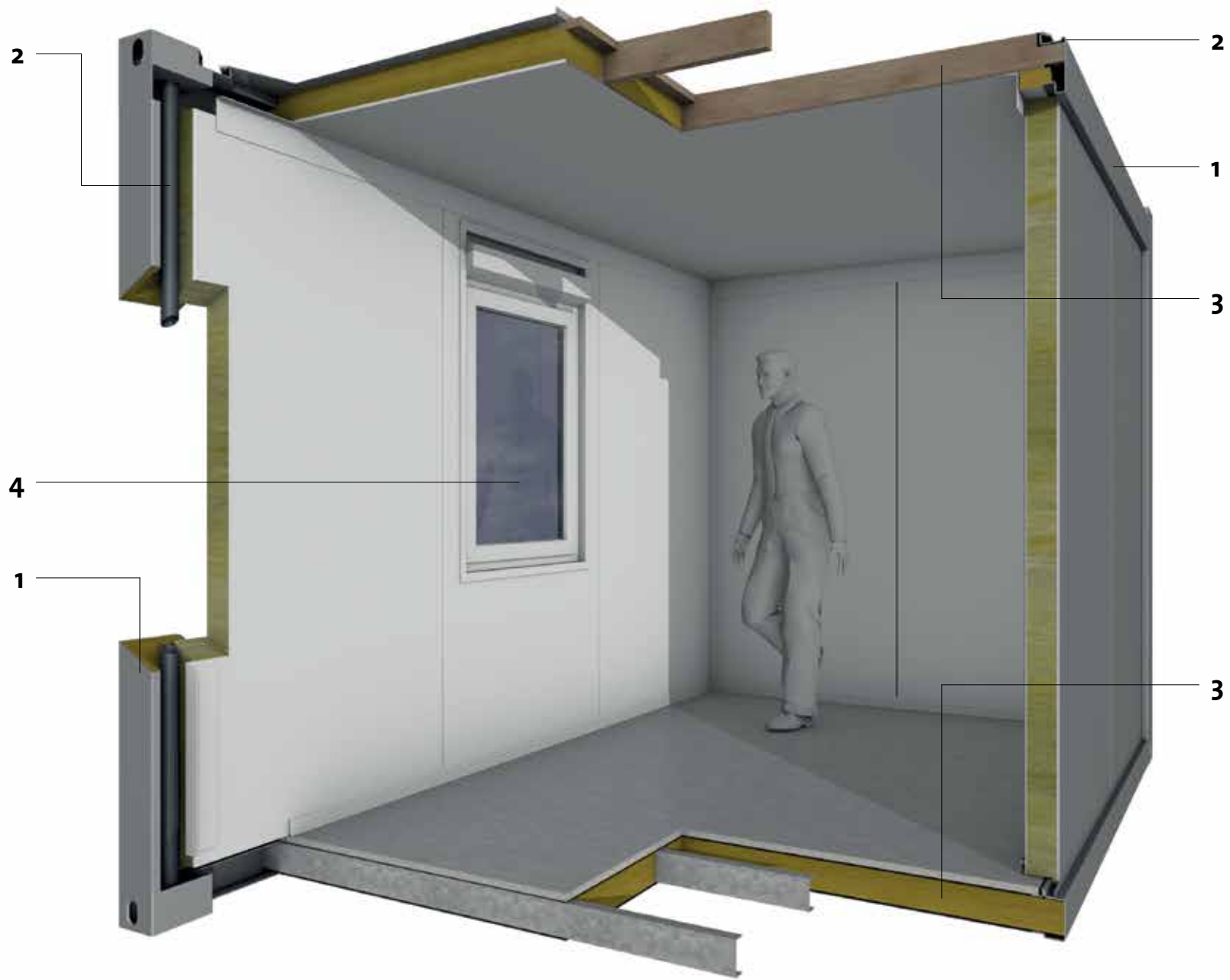

Standardised 20' modular space unit; exploded perspective

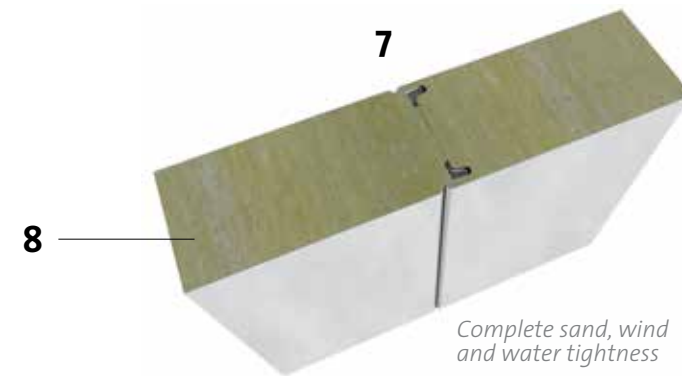

TRIMO Modular Unit

1. Steel framework

Designed as a light construction Trimo modular units enable easy handling and linking of individual modular units in both longitudinal and transverse directions without any limitations. Top steel quality and different types of corrosion protection allow them to be used in toughest climatic conditions.

2. Drainage

A rainwater channel incorporated in the roof frame, enables water drainage from the roof through PVC rainwater downpipes, located within every corner column.

3. Floors and ceilings

Completely pre-assembled and insulated with mineral wool. Exterior surfaces are protected with steel sheet, which are inclined towards rainwater channels at the roof. Various interior finish materials are available.

4. Windows & doors

Standard or highly insulated, top quality windows and doors with wide range of additional equipment.

5. Easy to transport and re-locate

Solid enough to enable handling by any ISO means (crane, forklift, spreader etc.) and can be transported by all kind of vehicles. Produced fully factory assembled or flat-packed to reduce transportation costs.

6. Long term economic benefits

Easy to build and install, they can be assembled and dissembled several times allowing them to be used on many consecutive projects over a long time period.

7. Thermal and sound insulation

Using various Trimo FTV fireproof panels of 60 to 240 mm thickness, thermal conductivity values (U) as low as 0.17 W/m²K can be guaranteed as well as an Rw sound reduction of 32 dB.

8. High density rock wool

100-120 kg/m³ assures vertical consistency and prevents heat bridges during the whole life span of the product.

9. Completely fire proof solution

Walls are made of "A1" class non - combustible materials, are completely recyclable and environmental friendly. EI Fire resistance class certified (EI30 - EI240).

10. Various profiles and custom colours

Various faced profiles are available to meet customers' demands and any colour from the RAL colour-chart.





Technical Data

Dimensions

Type of Unit	external LxW [mm]	internal LxW [mm] ¹
10'	2989 x 2435	2809 x 2255
16'	4880 x 2435	4700 x 2255
20'	6055 x 2435	5875 x 2255
24'	7325 x 2435	7145 x 2255
30'	9125 x 2435	8945 x 2255

Standard unit heights are 2591 mm (int. 2326 mm) and 2765 mm (int. 2500 mm). Other non-standard modular units sizes can be manufactured; length up to 40', width up to 12', height up to 12'.

Loadings

	Standard	Optional
Floor load	2.00 kN/m ²	3.00 kN/m ²
Roof (snow) load	1.00 kN/m ²	2.00 kN/m ²
Wind load	0.50 kN/m ²	1.00 kN/m ²

U Thermal transmittance

	Standard	Optional
Floor	0.34 W/m ² K	0.24 W/m ² K
Roof	0.33 W/m ² K	0.18 W/m ² K
Walls	0.61 W/m ² K	0.26 W/m ² K
Windows	1.60 W/m ² K	1.30 W/m ² K
Doors	1.90 W/m ² K	1.60 W/m ² K

¹ Valid for wall thickness 60 mm

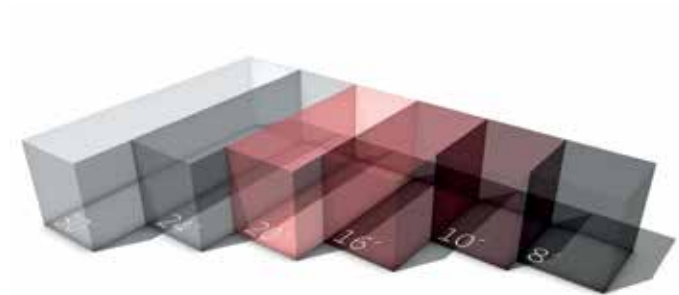



ABLU408034

26667

ABLU408033

26666



Cemetery building, Domžale, Slovenia



References

- Commercial 
- Hospitality 
- Education 
- Industrial 
- Government 





Sales Kiosk, Novo mesto, Slovenia



"MINI" Showroom Ljubljana, Slovenia





Motel Pelikan, Dettelbach, Germany







Kindergarten Ajda, Ravne na Koroškem

Building type:
Country:

Education
Slovenia

Kindergarten Ajda is an extension of a kindergarten in Ravne na Koroškem. Since modular construction proved to be a quick, flexible, energy and price efficient solution, the local authorities commissioned the new, permanent kindergarten extension to be built out of containerised modules.

The execution of the project took only 45 days and today children enjoy the pleasant playing environment within spacious classrooms (a height of more than 3 m) and terraces dressed in wood. The secondary façade envelope proved to have low energy building characteristics too. Also of benefit, the kindergarten was constructed to a budget lower than is typical for an average Slovene kindergarten.

An innovative approach by designers uses the façade interface as a large creative board with magnetic labels. The appearance of the kindergarten dynamically changes every day and combines modern design with the creativity of a child.

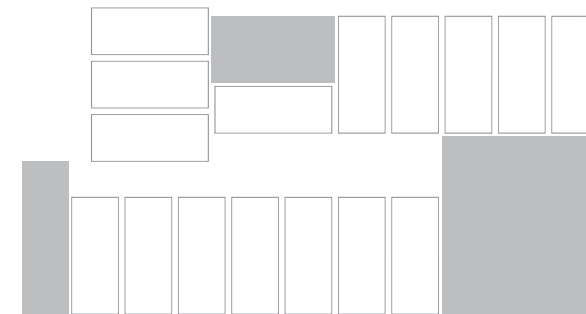

Jure Kotnik, Architect & autor of a Container Architecture book

“Good container architecture is useful, spacious, energy efficient, and made from environmentally friendly materials. The Kindergarten Ajda combines comfortable surroundings with bright and spacious playrooms as well as ensuring large and expansive play areas in outdoor covered terraces. The kindergarten is also home to the first magnetic educational façade anywhere in the world.”



Kindergarten Brezovica, Slovenia



Kindergarten Podpeč, Brezovica

Building type:
Country:

Education 
Slovenia

Brezovica municipality has been facing the challenge of solving a room shortage issue within kindergartens. The challenge was to find a fast, high quality, durable and cost-effective solution, which would provide quality and safe living space for about 75 children.

Trimo has designed and provided a mobile solution which meets all standards and regulations, using top-quality contemporary materials and advanced manufacturing procedures as well as having a guaranteed long life-span. Safety and comfort of the living area are in compliance with all current kindergarten-related regulations and standards for the Republic of Slovenia: an ensured minimum interior height of 3 m; and the compliance with, or rather exceeded required safety and living standards.

Multi-functionality and a favorable price were the main advantages that were recognized by investors when selecting Trimo's modular solutions are the best option for their problems. Cost reductions are assessed on a monthly basis because the energy efficient design brought even greater savings than was expected at the start of the project.

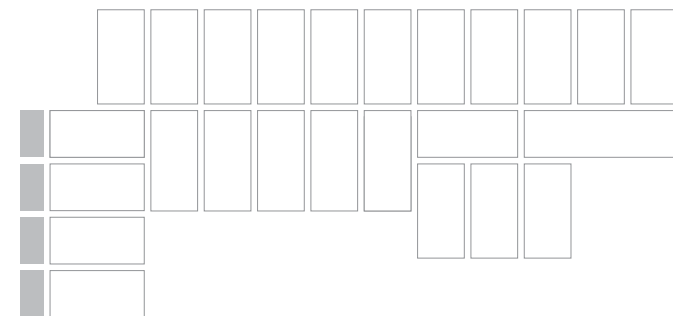





Kindergarten Škofja Loka

Building type:
Country:

Education 
Slovenia

The new building for the modular kindergarten is the result of excellent cooperation between the municipality of Škofja Loka, project designers, and Trimo. In the shortest of time Škofja Loka was faced with the problem of having to secure space for more than 150 children. Choosing modular construction enabled quick planning and implementation, which allowed the kindergarten, with 9 playrooms, to be built in just 60 days.

The well-furnished kindergarten has spacious playrooms with terraces as well as all the necessary auxiliary rooms. The additional façade coating provides energy efficiency and an ideal climate without having to install air conditioning.

The initial reservation of parents and kindergarten staff towards a modular solution was quickly replaced by enthusiasm as now all parents from Škofja Loka would like to take their children to attend the newly built kindergarten.

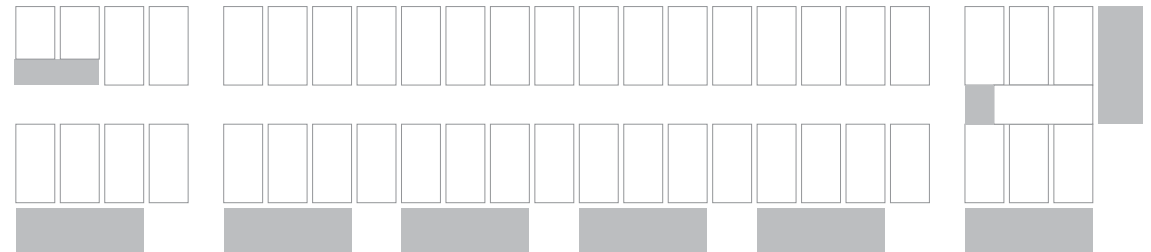



ModSpace HQ™ ground - level office, USA



Al Wasita remote site camp, United Arab Emirates



Al Wasita Remot Site Camp, UAE

Al Wasita working camp was built as a long-term occupancy camp for workers and their equipment in Suwaihat region. This is a remote site in the UAE where quite a considerable amount of important industrial and energy infrastructure for the country is being built and Trimo has built a camp for accommodating up to 3000 men.

Facilities included gym, mosque, restaurant, kitchen and accommodation buildings and all of Trimo's modular buildings met the necessary certificated standards and fire ratings, as defined by the Civil Protection Agency.

Building type:
Country:

Industrial 
United Arab Emirates

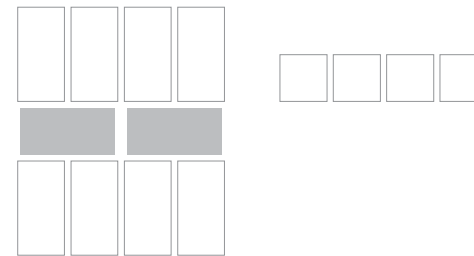

Basel T.C. Yaghnam, Chief Operating Officer, Al Wasita Emirates for Services & Catering L.L.C

“We have provided a high quality and cost-effective camp solution that exceeded all customer’ needs and requirements. The customer expressed that in his opinion, “this is one of the best remote site camps in region” of which we are very pleased.”



Oil field pilot Camp, Southern Algeria



Oil Field Pilot Camp, Algeria

This remote site camp was built for a client who needed accommodation for workers in the remote site of an oil field in Algeria. Harsh desert conditions required a solution with high quality of panel isolation and panel joints to prevent sand penetration into the building. Trimo has supplied VIP high quality modular units that exceeded all client's requirements and expectations.

Building type:
Country:

Industrial 
Southern Algeria





Work facilities, Libya



Work Facilities in Libya

A camp facility in Libya was required as a remote base unit for a construction company that was tasked with building about 400 km of roads.

The camp was built for 200 workers and has living, office, sanitary, kitchen and laundry facilities and shelters. Trimo was selected to complete the project due to the high quality of the product, and the ability to offer a complete end-to-end solution from project definition to the production of the units, delivery on site and assembly. All this within the required time frame demanded for the completion of the camp. A total of 207 containers with all equipment were finished in 2009.

Building type:
Country:

Industrial 
Libya







Free Zone Authority, United Arab Emirates

Fujairah Free Zone is a growing business hub for investors across the globe. As a part of their service expansion, our client Fujairah Free Zone authority decided to erect three G+2 office buildings at its main entrance.

A total of 350 Trimo modular units, with approximately 5200 m² area has been used to make 150 spacious offices in 3 buildings arranged in a “U” shaped. Our client was so happy with the modular concept and fast track assembly of Trimo’s modular buildings they have subsequently given us an order for another two buildings, again in the Free Zone. Phase one of the construction used 36 Trimo Modular units, with a further 24 Trimo Modular Units being used for phase 2.

Building type:
Country:

Government 
United Arab Emirates

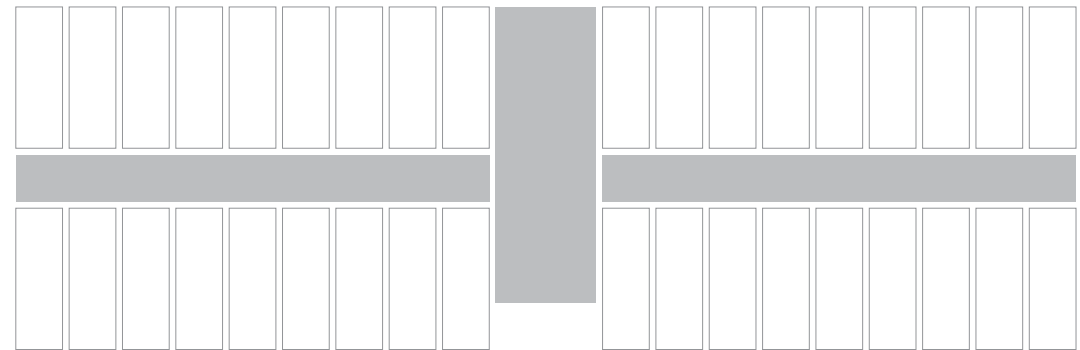

Sharief Habib Al-Awadhi, Director General, Fujairah Free Zone Authority

“Our experience with Trimo UAE FZE, across several Projects, demonstrated Trimo’s high level of commitment to providing excellence in job performance, and to ensuring the complete satisfaction of its customers.”



Military camp, Bosnia and Hercegovina



Qbiss Air, Glass Curtain Wall System



Trimoterm, Fireproof Roofs and Facades



Qbiss One, Metal Modular Facade System



Trimo Modular Space Solutions



Qbiss One with ArtMe, Design Solution



Trimo Steel Construction



Trimo MSS, Modular Space Solutions, d.d.

Prijateljeva cesta 12
8210 Trebnje
Slovenia

t: +386 (0)7 34 83 500
t: +386 (0)7 34 60 103
e: modularunits@trimo.si

